

HabasitLINK®

M3840 Radius Flush Grid 1.5"



Description

- For radius and straight conveying (collapse factor 2.2)
- 31% open area; 50% open contact area; largest opening 7x19 mm (0.27"x0.75")
- Excellent for cooling and draining
- Open hinge
- Easy to clean
- Food approved materials available
- Rod diameter 6 mm (0.24")

Available accessories

- Flights
- Sideguards
- Hold down devices
- GripTop modules
- Lane divider

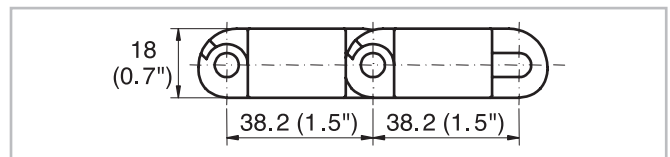
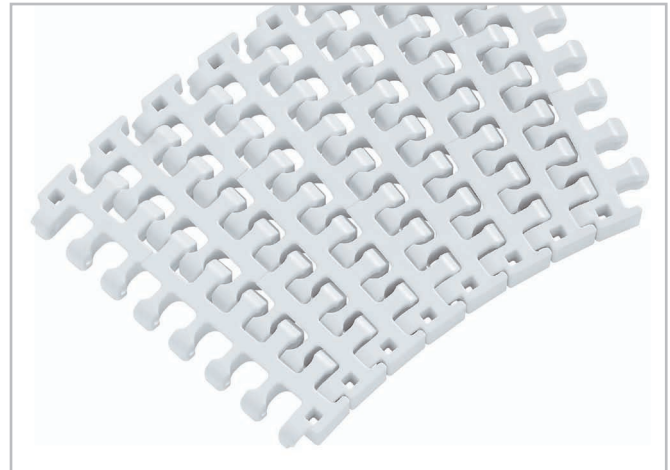

Belt data

Belt material		PP		POM	
Rod material		POM		PA	
Nominal tensile strength F'_N straight run	N/m lb/ft	23000 1575	23000 1575	32000 2192	
Nominal tensile strength F_N in curve ⁽¹⁾	N lbf	2000 450	2000 450	2400 540	
Temperature range	°C	5 - 93	5 - 105	-40 - 93	
	°F	40 - 200	40 - 220	-40 - 200	
Belt weight m_B	kg/m ²	8.0	8.0	11.8	
	lb/sqft	1.64	1.64	2.42	

⁽¹⁾ For $b_0 > 450$ mm (18") higher values admissible. Refer to LINK-SeleCalc

Diameter of idling rollers (minimum)		Diameter of support rollers (minimum)		Diameter for gravity take-up and center drive rollers (minimum)		Backbending radius for elevators without sideguards or hold down devices (minimum)		Backbending radius for elevators with sideguards or hold down devices (minimum)	
mm	inch	mm	inch	mm	inch	mm	inch	mm	inch
60	2.4	100	4	150	6	150	6	250	10

Use the largest possible backbending radius for elevators with side guards or hold down devices.

HabasitLINK®

M3840 Radius Flush Grid 1.5"



Standard range of belt widths b_0 and collapse factor Q ($R_{min} = Q \times b_0$)

Belt width mm (nom.)	200	250	300	350	400	450	500	550	600	650	700	750	800	850
Belt width inch (nom.)	8	10	12	14	16	18	20	22	24	26	28	30	32	34
Coll.fact. Q	1.85	1.92	1.96	1.99	2.02	2.03	2.05	2.06	2.07	2.08	2.09	2.09	2.10	2.10
Belt width mm (nom.)	900	950	1000	1050	1100	1150	1200	etc.						
Belt width inch (nom.)	36	38	40	42	44	46	48	etc.						
Coll.fact. Q	2.11	2.11	2.11	2.12	2.12	2.12	2.13	etc.						

Belt widths larger than 1200 mm (48") are not recommended; *please contact Habasit*.
Real belt widths are in most cases 0.1% to 0.3% smaller.

Standard belt widths in increments of 50 mm (2"). Non-standard widths are offered in increments of 25 mm (1"). Smallest possible width 175 mm (7").

For detailed material properties refer to the HabasitLINK® Engineering Guidelines or contact your Habasit representative.

The nominal tensile strength is valid for 23 °C (73 °F). The admissible tensile force depends on the operating temperature near the drive sprockets. Within the temperature range allowed, the admissible tensile force may vary from 100% to 20% of the nominal tensile strength. For detailed information and correct calculation of effective tensile force refer to the Calculation Guide in the HabasitLINK® Engineering Guidelines.

Product liability, application considerations

If the proper selection and application of Habasit products are not recommended by an authorized Habasit sales specialist, the selection and application of Habasit products, including the related area of product safety, are the responsibility of the customer. All indications / information are recommendations and believed to be reliable, but no representations, guarantees, or warranties of any kind are made as to their accuracy or suitability for particular applications. The data provided herein are based on laboratory work with small-scale test equipment, running at standard conditions, and do not necessarily match product performance in industrial use. New knowledge and experiences can lead to modifications and changes within a short time without prior notice.

BECAUSE CONDITIONS OF USE ARE OUTSIDE OF HABASIT'S AND ITS AFFILIATED COMPANIES CONTROL, WE CANNOT ASSUME ANY LIABILITY CONCERNING THE SUITABILITY AND PROCESS ABILITY OF THE PRODUCTS MENTIONED HEREIN. THIS ALSO APPLIES TO PROCESS RESULTS / OUTPUT / MANUFACTURING GOODS AS WELL AS TO POSSIBLE DEFECTS, DAMAGES, CONSEQUENTIAL DAMAGES, AND FURTHER-REACHING CONSEQUENCES.