

HabasitLINK®

M3843 Tight Radius 1.5"



Description

- For radius and straight conveying, ideal for applications with limited space (collapse factor 1.6)
- 37% open area; 50% open contact area; largest opening 9x18 mm (0.35"x0.7")
- Excellent for cooling and draining
- Easy to clean
- Food approved materials available
- Rod diameter 6 mm (0.24")
- "Open window" sprockets

Available accessories

- Flights: Minimum indent 105 / 95 mm (4.1" / 3.7")
- Sideguards
- Hold down modules

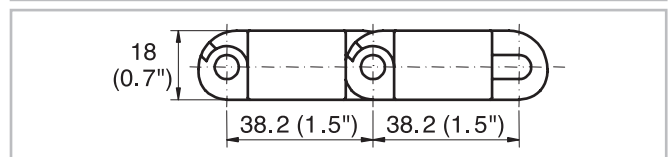

Belt data

| Belt material | | PP | | POM | |
|--------------------------------------------------------|-------------------|----------|----------|----------|-----------|
| Rod material | | POM | | PA | |
| Nominal tensile strength F'_N straight run | N/m | 20000 | 20000 | 20000 | 29000 |
| | lb/ft | 1370 | 1370 | 1370 | 1986 |
| Nominal tensile strength F_N in curve ⁽¹⁾ | N | 1800 | 1800 | 1800 | 2250 |
| | lbf | 405 | 405 | 405 | 506 |
| Temperature range | °C | 5 - 93 | 5 - 105 | 5 - 105 | -40 - 93 |
| | °F | 40 - 200 | 40 - 220 | 40 - 220 | -40 - 200 |
| Belt weight m_B | kg/m ² | 8.0 | 8.0 | 8.0 | 11.8 |
| | lb/sqft | 1.64 | 1.64 | 1.64 | 2.42 |

⁽¹⁾ For $b_0 > 600$ mm (23.6") higher values admissible. Refer to LINK-SeleCalc.

| Diameter of idling rollers (minimum) | | Diameter of support rollers (minimum) | | Diameter for gravity take-up and center drive rollers (minimum) | | Backbending radius for elevators without sideguards or hold down devices (minimum) | | Backbending radius for elevators with sideguards or hold down devices (minimum) | |
|--------------------------------------|------|---------------------------------------|------|-----------------------------------------------------------------|------|------------------------------------------------------------------------------------|------|---------------------------------------------------------------------------------|------|
| mm | inch | mm | inch | mm | inch | mm | inch | mm | inch |
| 60 | 2.4 | 100 | 4 | 150 | 6 | 150 | 6 | 250 | 10 |

Use the largest possible backbending radius for elevators with side guards or hold down devices.

HabasitLINK®

M3843 Tight Radius 1.5"



Standard range of belt widths b_0 and collapse factor Q ($R_{min} = Q \times b_0$)

| | | | | | | | | | | | | | | | |
|------------------------|------|------|------|------|------|------|------|------|------|------|------|------|------|------|------|
| Belt width mm (nom.) | 250 | 300 | 350 | 400 | 450 | 500 | 550 | 600 | 650 | 700 | 750 | 800 | 850 | 900 | 950 |
| Belt width inch (nom.) | 10 | 12 | 14 | 16 | 18 | 20 | 22 | 24 | 26 | 28 | 30 | 32 | 34 | 36 | 38 |
| Coll.fact. Q | 1.50 | 1.53 | 1.55 | 1.57 | 1.59 | 1.60 | 1.61 | 1.62 | 1.62 | 1.63 | 1.63 | 1.64 | 1.65 | 1.66 | 1.68 |
| Belt width mm (nom.) | 1000 | 1050 | 1100 | 1150 | 1200 | | | | | | | | | | |
| Belt width inch (nom.) | 40 | 42 | 44 | 46 | 48 | | | | | | | | | | |
| Coll.fact. Q | 1.70 | 1.72 | 1.73 | 1.75 | 1.76 | | | | | | | | | | |

Belt widths larger 1200 mm (48") not recommended; *please contact your Habasit representative.*
Real belt widths are in most cases 0.1% to 0.3% smaller.

Standard belt widths in increments of 50 mm (2"). Non-standard widths are offered in increments of 25 mm (1"). Smallest possible width 175 mm (7").

For detailed material properties refer to the HabasitLINK® Engineering Guidelines or contact your Habasit representative.

The nominal tensile strength is valid for 23 °C (73 °F). The admissible tensile force depends on the operating temperature near the drive sprockets. Within the temperature range allowed, the admissible tensile force may vary from 100% to 20% of the nominal tensile strength. For detailed information and correct calculation of effective tensile force refer to the Calculation Guide in the HabasitLINK® Engineering Guidelines.

Product liability, application considerations

If the proper selection and application of Habasit products are not recommended by an authorized Habasit sales specialist, the selection and application of Habasit products, including the related area of product safety, are the responsibility of the customer. All indications / information are recommendations and believed to be reliable, but no representations, guarantees, or warranties of any kind are made as to their accuracy or suitability for particular applications. The data provided herein are based on laboratory work with small-scale test equipment, running at standard conditions, and do not necessarily match product performance in industrial use. New knowledge and experiences can lead to modifications and changes within a short time without prior notice.

BECAUSE CONDITIONS OF USE ARE OUTSIDE OF HABASIT'S AND ITS AFFILIATED COMPANIES CONTROL, WE CANNOT ASSUME ANY LIABILITY CONCERNING THE SUITABILITY AND PROCESS ABILITY OF THE PRODUCTS MENTIONED HEREIN. THIS ALSO APPLIES TO PROCESS RESULTS / OUTPUT / MANUFACTURING GOODS AS WELL AS TO POSSIBLE DEFECTS, DAMAGES, CONSEQUENTIAL DAMAGES, AND FURTHER-REACHING CONSEQUENCES.